

# FL-720

## OUTDOOR LIGHTING LUMINAIRE

Project \_\_\_\_\_  
Location \_\_\_\_\_  
Quote/ Ref # \_\_\_\_\_

The **FL-720** is an outdoor LED accent light with multiple beam and shroud options. It can rotate 360° and can be tilted 180° allowing for a more precise lighting scheme. Various accessories are available for different mounting options. Made of die-cast aluminum, it is extremely durable to ensure a longer lifetime. Its optimized heat dissipation allows the luminaire to be operated in extended lengths of time. Suitable for outdoor lighting such as building facades, gardens, lawns, tree accent lighting, and common outdoor areas



### SPECIFICATIONS

INPUT VOLTAGE	120V AC   120-277V
WATTAGE	10W   15W
LUMEN OUTPUT	70Lm/ W
HOUSING	Die-cast Aluminum
GASKET	Silicone Rubber
FRONT COVER	Tempered Glass
LED OPTIC	Polycarbonate Lens
FINISH TYPE	AkzoNobel Powder Coating
DRIVER TYPE	Constant Current (Built-In)
DIMMING	0-10V and TRIAC
AMBIENT TEMPERATURE	-4°F (-20°C) ~ 113°F (45°C)
IP RATING	IP65
CERTIFICATIONS	ETL Listed

### FEATURES

- 120V AC | 120-277V
- 10W | 15W
- Multiple Beam Patterns
- 360° Rotate | 180° Tilt
- Die-cast Aluminum Housing
- IP65 Outdoor/ Wet Rated
- Multiple Beam Patterns



MODEL	WATTS	CCT	OPTICS	CRI	SHROUD	FINISH	DIMMING	VOLT	ACCESSORIES	
FL-720	10 10W	27K 2700K	15 15°	80 Ra80	NS No Shroud	BLK Black	TRI <sup>1</sup> TRIAC Dimming	120 120V	KC 4.5" Round Cover	HC Honeycomb Louver
	15 15W	30K 3000K	25 25°	90 Ra90	AS Angled Glare Shield	WH White	D10 <sup>2</sup> 0-10V Dimming	UNV 120-277V	JB Junction Box	MR Marine Ambient Corrosion Resistant
		35K 3500K	36 36°		OS Straight Glare Shield	GR Gray	ND No Dimming		SHV High Voltage Ground Stake	PC Pole Clamp
		40K 4000K	50 50°			BZ Bronze				
	50K 5000K		HV H50° x V20°		SI Silver			PJB Tree Strap with Junction Box	MBS* Large Enclosure Box	
							1 = 120V Only 2 = 120-277V Only; Requires MBS Large Enclosure Box		* Required for 0-10V Dimming	

# FL-720

## OUTDOOR LIGHTING LUMINAIRE

### DIMENSIONS

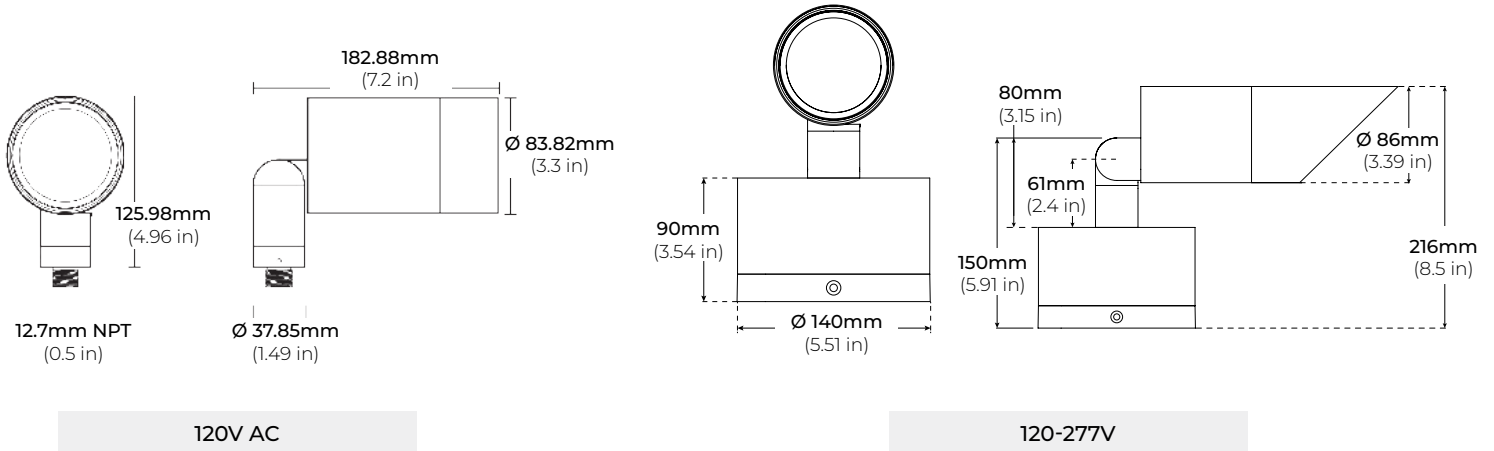

### SHROUDS

AS  
ANGLED RETRACTABLE

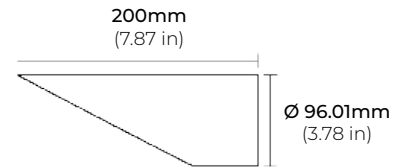

OS  
OPEN STRAIGHT RETRACTABLE

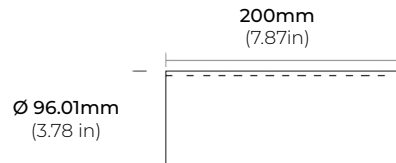

### ACCESSORIES

FL700-KC  
4.5" ROUND COVER

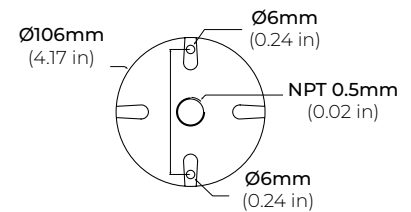

FL700-JB  
JUNCTION BOX

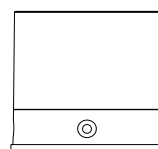

72mm  
(2.83 in)

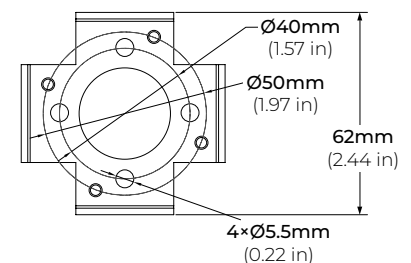
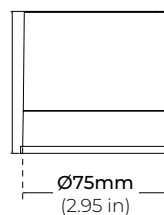

# FL-720

## OUTDOOR LIGHTING LUMINAIRE

### ACCESSORIES

**FL700-MBS**  
LARGE ENCLOSURE BOX

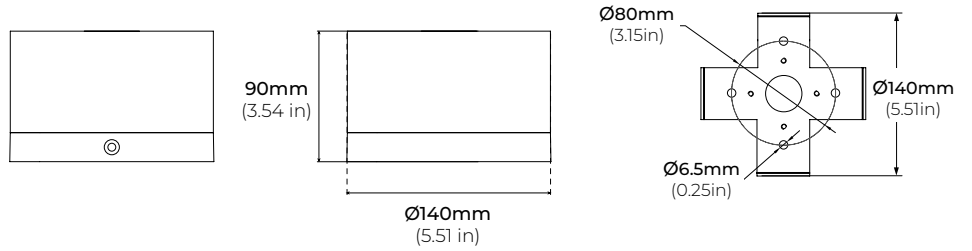

**FL700-SHV**  
HIGH VOLTAGE GROUND STAKE

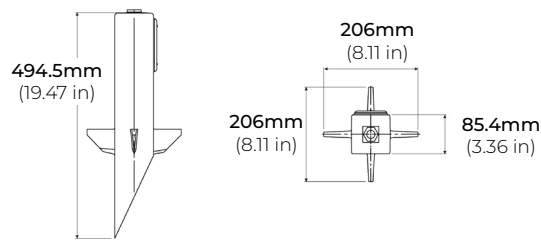

**FL700-PJB**  
TREE STRAP WITH JUNCTION BOX

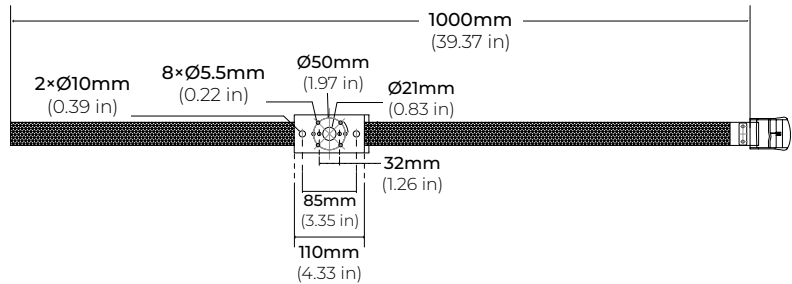

**FL700-HC**  
HONEYCOMB LOUVER

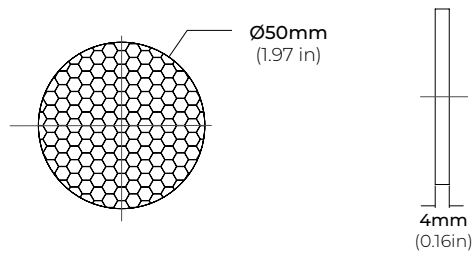

**FL700-PC**  
POLE CLAMP

