

# ST-300

## 2W INDOOR/ OUTDOOR STEP LIGHT

**ROC**  
LIGHTING

UPDATED: 05.21.25

Project \_\_\_\_\_

Location \_\_\_\_\_

Quote/ Ref # \_\_\_\_\_

The **ST-300** is a 2W indoor/outdoor non-dimming LED steplight designed to provide safe illumination for paths and walkways with a stylish look. This versatile step light features a wide variety of trim plates and finishes to choose from. It is constructed of high impact, weather-resistant polycarbonate material and can last up to 50,000 hours, maintenance-free. The ST-300 can be mounted either vertically or horizontally.



### SPECIFICATIONS

INPUT VOLTAGE	12V AC/DC   120-277V
POWER CONSUMPTION	2W
LUMEN OUTPUT	65 Lumens
OUTPUT CURRENT	35mA
CRI	85+
COLOR TEMPERATURE	3000K / 4000K / Amber / Blue
DIMMING	No
IP RATING	IP65 (Wet Location)
FINISH	White / Bronze / Brushed Nickel
OPERATING TEMPERATURE	-4°F (-20°C) to 122°F (50°C)
AMBIENT TEMPERATURE	-4°F (-20°C) to 176°F (80°C)
CONNECTION	7" 18AWG Lead Wire
LUMEN MAINTENANCE	50,000 Hrs.
WARRANTY	3-Year Limited

### FEATURES

- Easy to install with single gang switch box
- Suitable for interior or exterior applications
- Louvered, Lensed and Visor face plate options
- Die-cast aluminum face plate
- Non-Dimmable



MODEL	COLOR TEMP	FACE PLATE		FINISH	VOLTAGE
ST300	<b>30K</b> 3000K	<b>HL</b> Horizontal Louver	<b>VL</b> Vertical Louver	<b>WH</b> White	<b>12V</b> 12V AC/DC
	<b>40K</b> 4000K	<b>HV</b> Horizontal Visor	<b>VV</b> Vertical Visor	<b>BZ</b> Bronze	<b>UNV</b> 120-277V
	<b>AM</b> Amber	<b>HW</b> Horizontal Wave	<b>VW</b> Vertical Wave	<b>BN</b> Brushed Nickel	
	<b>BL</b> Blue	<b>HDL</b> Horizontal Designer Louver	<b>VDL</b> Vertical Designer Louver		
		<b>LS</b> Lensed			

# ST-300

**ROC**  
LIGHTING

UPDATED: 05.21.25

## 2W INDOOR/ OUTDOOR STEP LIGHT

### DIMENSIONS

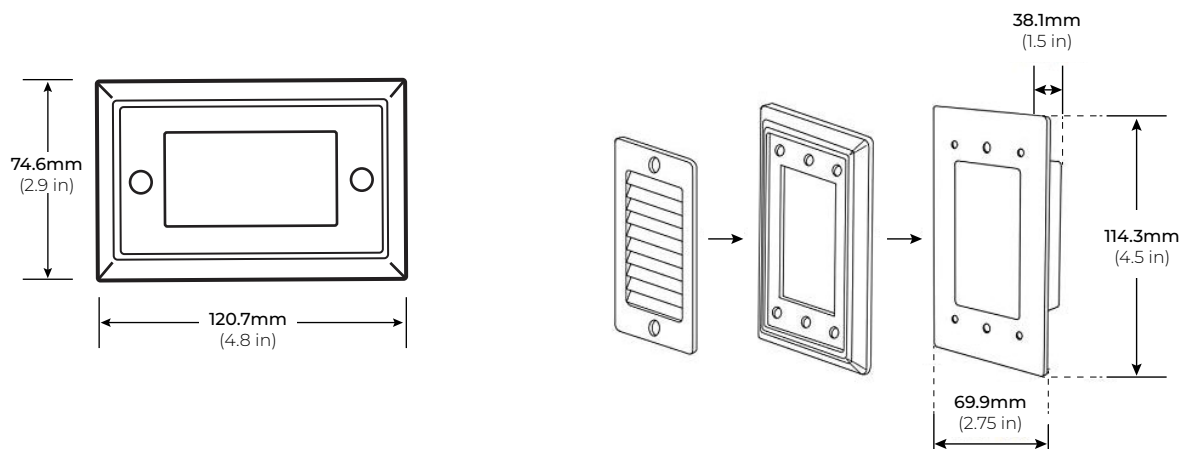

### FACE PLATES

**LS**  
LENSED



**HL**  
HORIZONTAL LOUVER



**HV**  
HORIZONTAL VISOR



**HW**  
HORIZONTAL WAVE



**HDL**  
HORIZONTAL DESIGNER LOUVER



# ST-300

2W INDOOR/ OUTDOOR STEP LIGHT

**ROC**  
LIGHTING

UPDATED: 05.21.25

## FACE PLATES

---

**VL**  
VERTICAL LOUVER



**VV**  
VERTICAL VISOR



**VW**  
VERTICAL WAVE



**VDL**  
VERTICAL DESIGNER LOUVER

